

EUL-SB-LED | LED elevated taxiway stop-bar light - Airsafe



COMPLIANCE:

- ICAO Annex.14, Vol I.
- FAA AC 150/5345-46
- UNE IEC-TS 61827
- EASA CS-ADR-DSN.
- STANAG 3316
- AENA PPT-015_06-12



BOARDING TIME

BOARDING PASS

NAME OF PASSANGER

FROM:

TO:

DATE

FLIGHT
GAES2020

GATE
23

SEAT
21B

GATE CLOSES 30 MINUTES BEFORE DEPARTURE

GAES 454843121451100

GOMINTEC

BOARDING PASS

GOMINTEC

Uses

LED elevated taxiway stop-bar light for airports CAT I, II & III, according to ICAO Fig A2-12.

Features

- Robust body built on high strength aluminum alloy, anti-corrosion treatment and excellent thermal dissipation.
- Reduced height to minimize the jet blast impact.
- Stainless steel hardware to grant the waterproof and corrosion resistance.
- Glass diffuser with high resistance to the temperature and abrasion.
- Long-life and robust design to guarantee the waterproof of the equipment over the years.
- Integrated electronic encapsulated in epoxy resin.
- Compatible with existing serial circuits without need of changing the isolation transformers.
- Regulated light output.
- Optional "Fail Open" monitoring device.
- Integrated surge protection.
- Efficient control of LEDs operating temperature, increasing the light life and avoiding color change.
- Saturated LED colors ensuring clear identification of the lights at all brightness levels and any viewing angle.
- The long-life of the equipments, with low maintenance and consumption, involve directly a reduction of operational costs.
- Optional anti-birds device available.

Specifications

- Power: 2.8A ~ 6.6A, according to FAA EB67.
- Average life: minimum 60.000h at maximum brightness and 100.000h in a normal operating conditions.
- Color: Red
- Consumption: $\leq 10VA$, $FP \geq 0.95$
- Index Protection: IP67
- Installation for 45W isolation transformer

EUL-SB-LED | LED elevated taxiway stop-bar light - Airsafe

Order Code

Type	<i>EUL-SB = Elevated taxiway stop-bar light</i>	EUL-SB	-	LED	-	R	-	X
Light source	<i>LED = LED lamp</i>			LED				
Beam color	<i>R = Red</i>					R		
Optional function	<i>M = Single lamp fault detection function</i>							

Installation

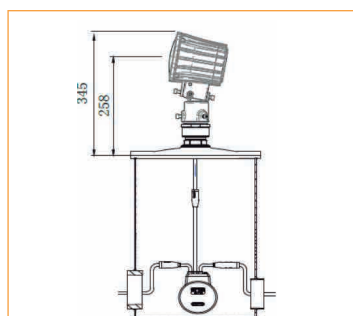

Figure 1
On 12" deep base

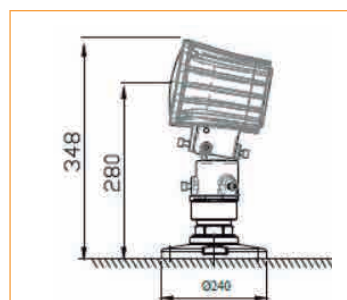
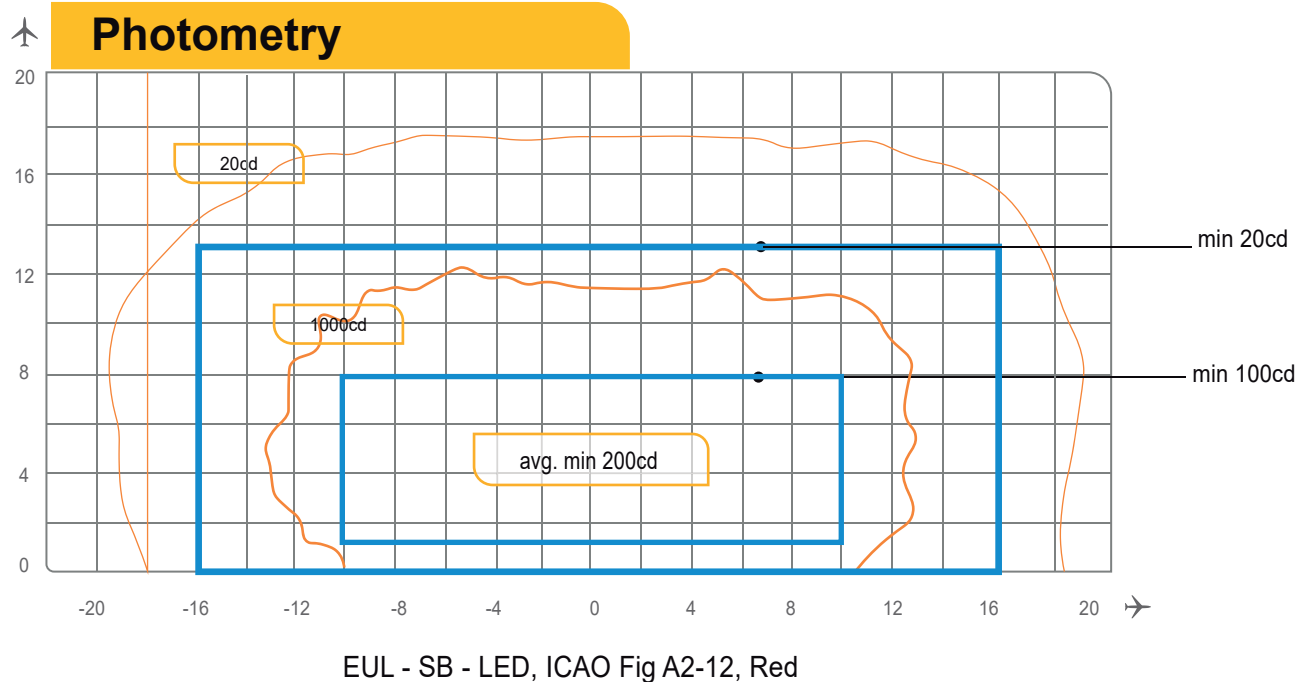
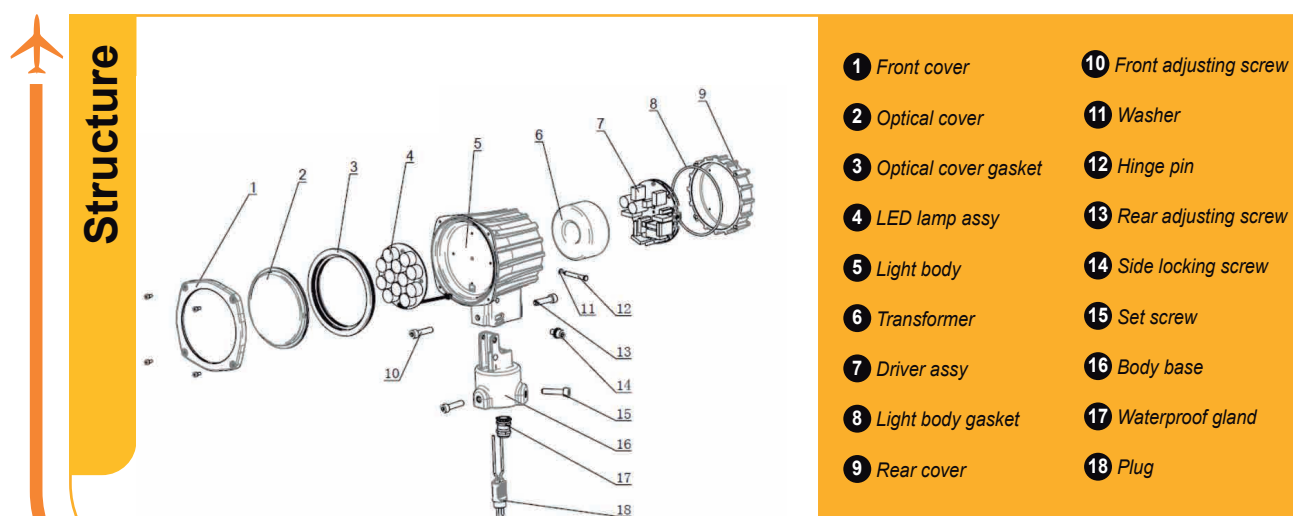

Figure 2
Flange direct mount

EUL-SB-LED | LED elevated taxiway stop-bar light - Airsafe



Application		Main beam		Color	Required min. avg. cd.	Actual avg. cd.
		H	V			
EUL-SB-LED	ICAO Fig. A2-12	$\pm 10^\circ$	1 a 8°	Red	200	380



EUL-SB-LED | LED elevated taxiway stop-bar light - Airsafe

Spare Parts

N°	Order No.	Description
2	31108	Optical cover
3	41110	Optical cover gasket
4	979242-12-R	Lamp
6	79125	Transformer
8	41154	Light body gasket
17	48401	Waterproof gland
18	HT70603	Secondary cable connector A6
19	942124	Lamp holder

Accessories

N°	Order No.	Description
1	FL-10	Flange 10"
2	FL-12-X-G2	Flange 12"
3	FC-02	Frangible coupling (2")
4	ITF-045-066	45W isolation transformer
5	REC 7	Secondary cable connector style 7
6	954211	Corrector
7	TJB-12	Isolation transformer box

Weight and Dimensions

- | | |
|-------------------------|---------------------------------|
| • Packaging size | 220 × 220 × 265 mm ³ |
| • Weight | 4,00 kg |