

RTIL-LED | LED runway threshold identification light - Airsafe



COMPLIANCE:

- ICAO Annex. 14, Vol.I
- FAA AC 150/5345-51
- IEC: 61827
- EASA: CS-ADR-DSN
- STANAG 3316



BOARDING TIME

BOARDING PASS

NAME OF PASSANGER

FROM:

TO:

DATE FLIGHT
 GAES2020

GATE SEAT
23 21B

GATE CLOSES 30 MINUTES BEFORE DEPARTURE

BOARDING PASS

Uses

LED sequenced flashing approach lighting system and runway threshold identification light for airports CAT I, II & III according FAA E-2628 and ICAO annex 14 Vol.I.

Features

- Unit control is integrated into light, wich has compact structure.
- Main body of the lighting fixtures is made of aluminium alloy material with anti-corrosion surface treatment and all fasteners are made of stainless steel.
- The main control cabinet and all unit cabinets have CPU, wich works independently and collaborative cooperation is achieved through the BUS communication.
- LED flash has low power consumption and high power factor.
- An eventual failure will not result in breakdown of system, ensuring reliable system operation.
- Monitoring system achieves remote control and uploads of operation status.
- Circuits, power and communication cables are equipped with lightning protection, conforming FAA requierements.
- Elevated lights for mounting on 1" or 2" frangible tube.
- Precision machined on fixing elements to meet ICAO and FAA frangibility requirements.
- Photometry and chromaticity according to requirements of sequenced flashing systems of the FAA E-2628.

Specifications

- Power: 230V ~ 50Hz
- Color: White
- Consumption: 44VA
- Index Protection: IP67.

RTIL-LED | LED runway threshold identification light - Airsafe

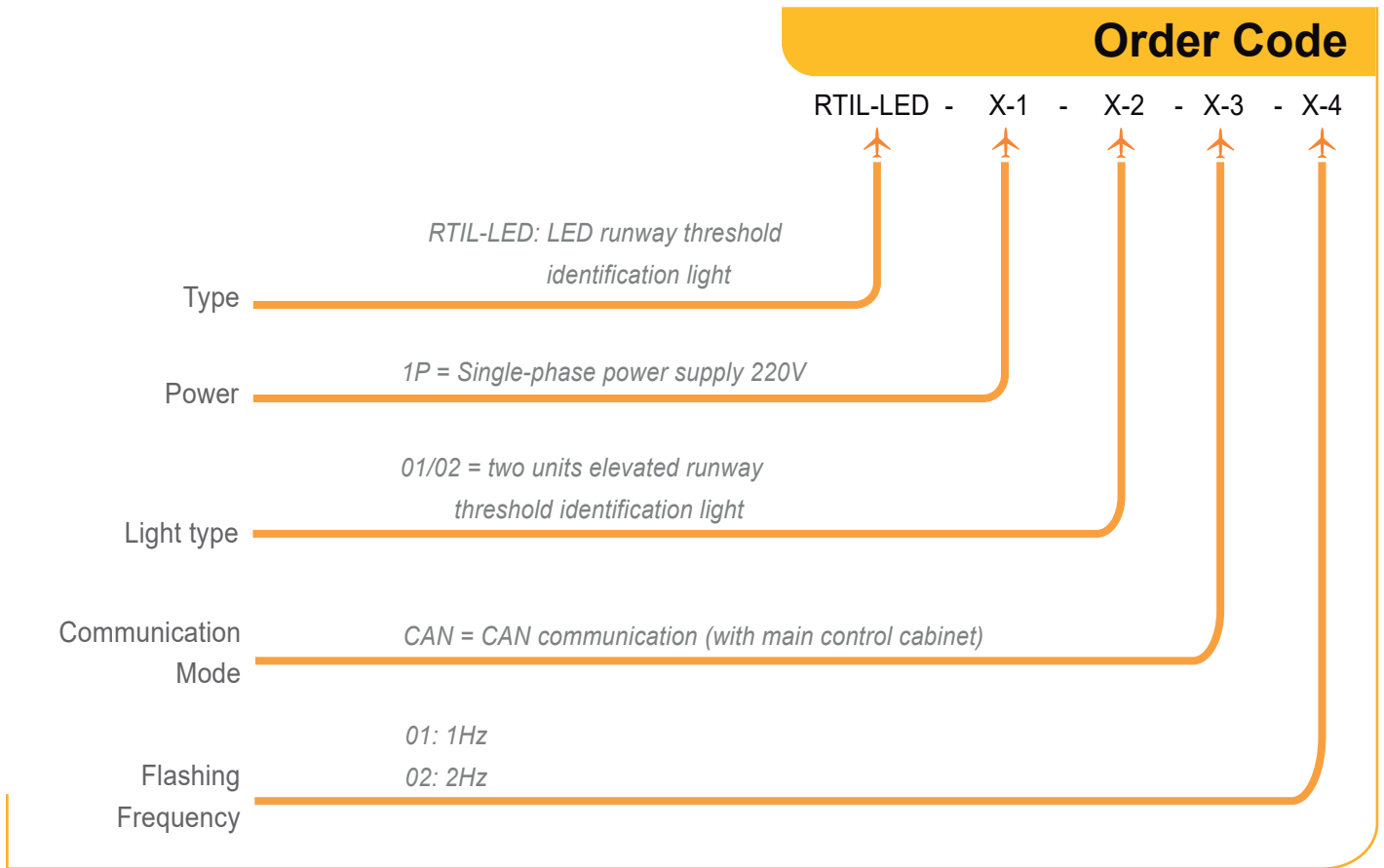

Installation

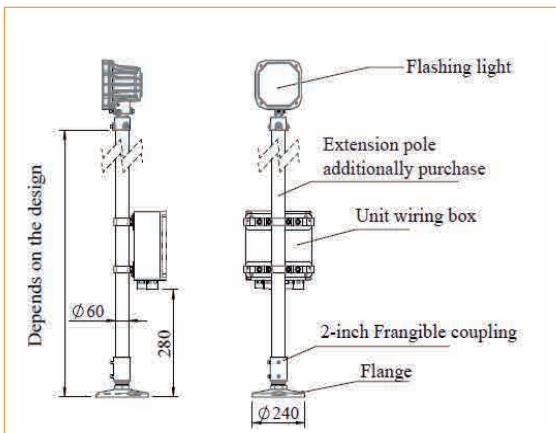

Figure 1
Elevated flashing light with upright pole installation Unit wiring box with backpack type installation

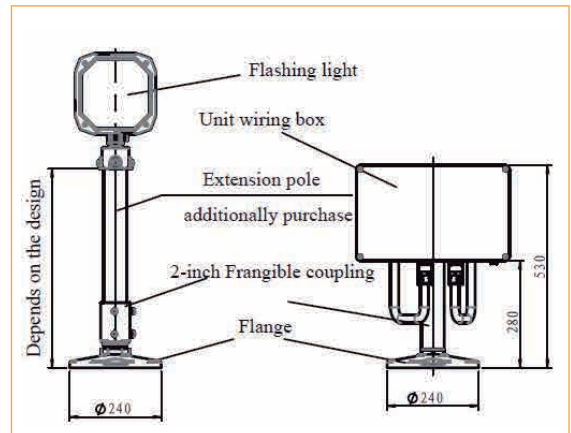

Figure 2
Elevated flash light upright pole installation Unit wiring box with supporting pole installation

RTIL-LED | LED runway threshold identification light - Airsafe



Installation

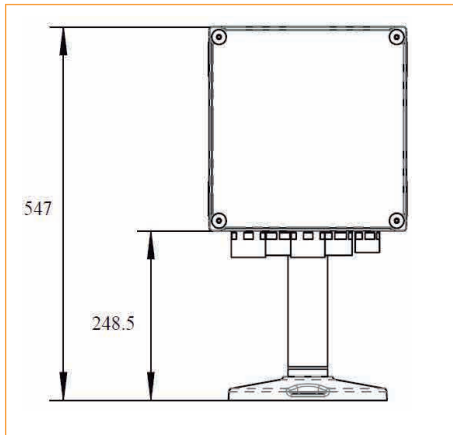

Figure 3
Installation of unit wiring box

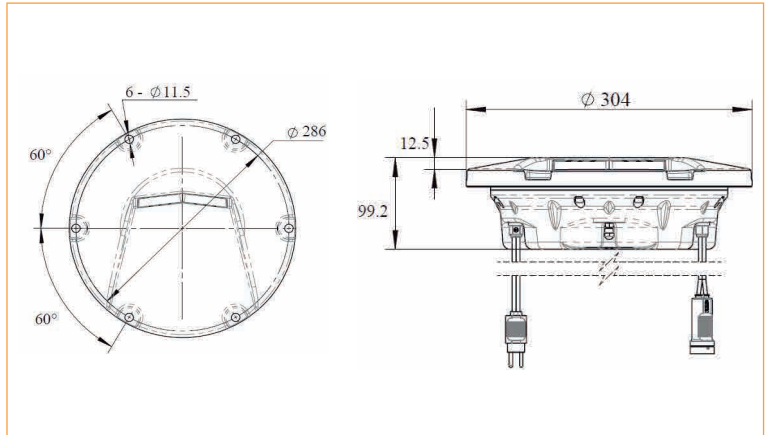
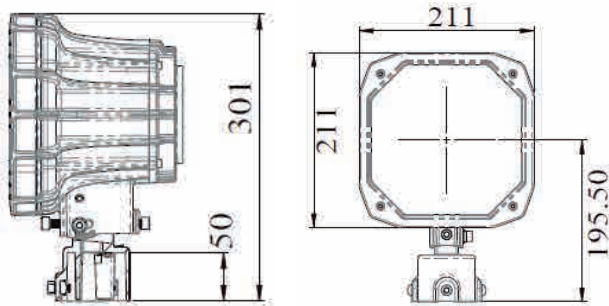

Figure 4
Installation of in-pavement flasher



Dimensions



Dimension of Elevated Flashing light

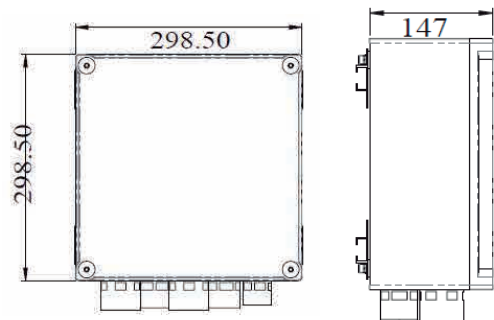

Dimension of the unit wiring box

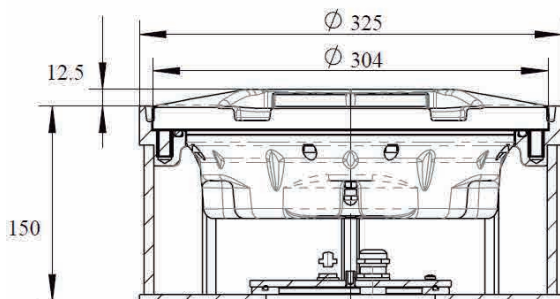

Dimension of the in-pavement flasher

RTIL-LED | LED runway threshold identification light - Airsafe

Technical Parameters

Elevated runway threshold identification light

Unit power	44VA
Beam angle	Horizontal $\pm 15^\circ$, Vertical 0-10°
Light intensity	I class 2% (150 - 450cd)
	II class 10% (750 - 2250cd)
	III class 100% (7500 - 22500cd)
Flash frequency	Once or twice per second, adjustable
Elevation angle	0 to 15 degrees vertical

In-pavement runway threshold identification light

Unit power	72VA
Beam angle	Horizontal $\pm 15^\circ$, Vertical 2-12°
Light intensity	I class 2% (150 - 450cd)
	II class 10% (750 - 2250cd)
	III class 100% (7500 - 22500cd)
Flash frequency	Once or twice per second, adjustable

Spare Parts

COMPONENT ORDER

N°	Order No.	Description
1	979302	Main control cabinet
2	66280	Elevated flashing light
3	79308-D	Unit wiring box
4	924252	Frangible coupling joint
5	FL-10	Flange
6	66440	In-pavement flasher
7	SB-12	Shallow Base

RTIL-LED | LED runway threshold identification light - Airsafe

Spare Parts

SPARE ARTICLES ORDER

N°	Order No.	Description
Main control cabinet	791A7	Main control screen
Elevated flashing light	41186	Optical cover gasket
	979248	LED assembly
	31159	Optical cover
	41188	Light body gasket
	924D11	Rear cover assembly
In-pavement flashing light	7927D	LED Assembly
	43112	Prism gasket sleeve
	31162	Prism - ISFL glass - right
	31161	Prism - ISFL glass - left
	41135	Light body gasket
	43315	Prism gasket
	4642K	Prism pressing bracket
Base	41115	Gasket

Accessories

N°	Order No.	Description
1	54220	Calibrator assembly

Weight & Dimensions

Packaging	Dimensions	Weight
1 x Main control cabinet	550 x 550 x 1400mm ³	55kg
1 x Elevated flashing light	262x 302 x 380mm ³	6,5kg
1 x Unit wiring box	440 x 350 x 550mm ³	9,5kg
6 x Flange	240 x 240 x 180mm ³	8,4kg
16 x Frangible coupling joint	340 x 340 x 190mm ³	12,3kg
1 x In-pavement flashing light	310 x 310 x 150mm ³	8,6kg
1 x Shallow Base	340 x 340 x 185mm ³	4,5kg