

## APPS-12-LED | LED In-pavement approach centerline/crossbar light - Airsafe



### Uses

LED in-pavement approach centerline / crossbar lights for airports CAT I, II & III, according to ICAO, Figure A2-1.

### Features

- 12" external diameter, with upper and lower cover manufactured on high strength forged aluminum, and only 6mm of profile over pavement.
- Stainless steel hardware.
- Surface treatment to prevent the wear and increase the corrosion resistance, which makes it especially resistant to dust and water.
- Smooth surface without sharpened edges to avoid damages at the aircraft tyres.
- Regulation according to FAA EB67E equivalent to a halogen lamp.
- Integrated surge protection.
- Efficient control of LEDs operating temperature, increasing the light life and avoid color change.
- High features optical design.
- Compatible with existing circuits of visual aids.

### Specifications

- Power: 2.8A ~ 6.6A, according to FAA EB67D.
- Average life: minimum 60.000h at maximum brightness and 100.000h in a normal operating conditions.
- Color: White
- Consumption: 72VA; FP >0,95
- Index Protection: IP68.

## APPS-12-LED | LED In-pavement approach centerline/crossbar light - Airsafe

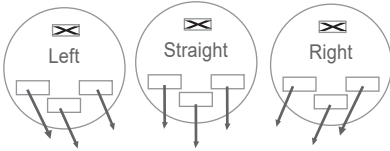
| Order Code         |  |
|--------------------|--|
| APPS-12 -          | X - LED - C - X  |
| Type               | APPS-12: In-pavement approach centerline light 12"   |
| Beam direction     | <p>Runway end</p> <p>S= Straight<br/>L = Left toe-in<br/>R = Right toe-in</p>  |
| Light source       | LED= LED lamp  |
| Color beam         | C = Clear (White)  |
| Optional functions | <p>M = Single lamp fault detection function<br/>A = Artic Kit</p>  |



### Installation

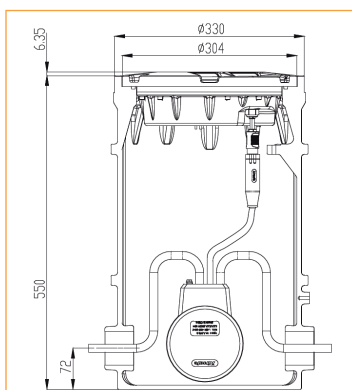

**Figure 1**  
On 12" deep base

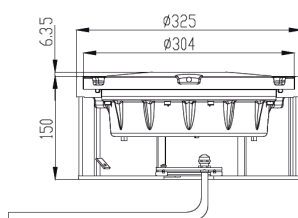

**Figure 2**  
On 12" shallow base

## APPS-12-LED | LED In-pavement approach centerline/crossbar light - Airsafe

### Photometry

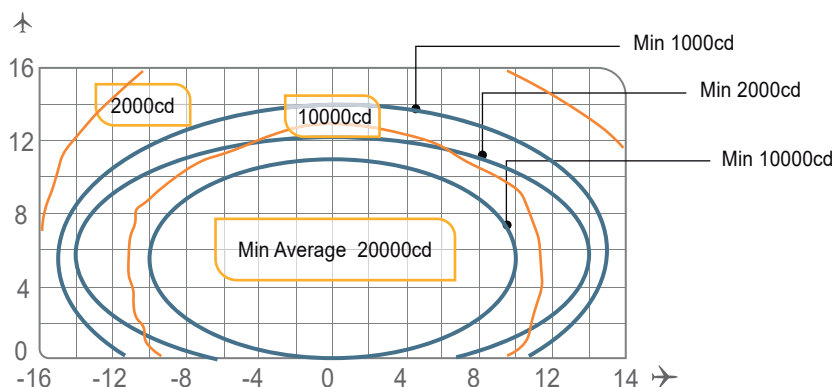

APPS-12-LED, ICAO Fig. A2-1, White

| Application |               | Main Beam      |                            | Color | Required min avg cd. | Actual avg. cd. |
|-------------|---------------|----------------|----------------------------|-------|----------------------|-----------------|
|             |               | H              | V                          |       |                      |                 |
| APPS-12-LED | ICAO Fig A2-1 | $\pm 10^\circ$ | $0^\circ$ a $11^\circ$     | White | 20.000               | 23.561          |
|             |               | $\pm 10^\circ$ | $0,5^\circ$ a $11,5^\circ$ | White | 20.000               | 23.687          |
|             |               | $\pm 10^\circ$ | $1,5^\circ$ a $12,5^\circ$ | White | 20.000               | 23.538          |
|             |               | $\pm 10^\circ$ | $2,5^\circ$ a $13,5^\circ$ | White | 20.000               | 23.569          |

### Structure

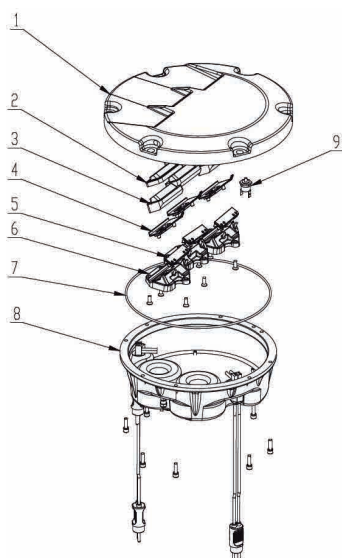

- 1 Upper cover
- 2 Prism gasket sleeve
- 3 Prism
- 4 LED lamp assy
- 5 Prism gasket
- 6 Prism pressing bracket
- 7 Light body gasket
- 8 Inner cover assy
- 9 Thermal switch

## APPS-12-LED | LED In-pavement approach centerline/crossbar light - Airsafe

### Spare Parts

| N° | Order No.     | Description            |
|----|---------------|------------------------|
| 2  | 43117         | Prism gasket sleeve    |
| 3  | 31158         | Prism                  |
| 4  | 932053-APPS-C | LED lamp assy          |
| 5  | 43316         | Prism gasket           |
| 6  | 43241         | Prism pressing bracket |
| 7  | 41135         | Body light gasket      |

### Accessories

| N° | Order No.   | Description                                     |
|----|-------------|---|
| 1  | SB-12       | 12" deep base                                   |
| 2  | DB-12       | 12" shallow base                                |
| 3  | 41115       | 12" base O-ring                                 |
| 4  | 51121       | 12" lamp handle                                 |
| 5  | ITF-100-066 | 100W isolation transformer                      |
| 6  | REC7        | Moulded type secondary cable receptable style 7 |



### Weight and Dimensions

|                       | Base                       | 12" shallow base           |
|-----------------------|----------------------------|----------------------------|
| <b>Packaging size</b> | 330x330x150mm <sup>3</sup> | 350x350x185mm <sup>3</sup> |
| <b>Weight</b>         | 9,7 kg                     | 14,260 kg                  |